



# PrimaVision Xtreme for CPO

## HID-PV Xt 45 CPO Q 208-277V

Highly reliable electronic drivers for CPO lamps; designed to save energy by offering better light efficiency than magnetic drivers and to reduce maintenance costs thanks to 80,000-hour lifetime and integrated lightning protection

### Product data

| General Information                            |               |
|--|---------------|
| Lamp type                                      | CPO           |
| Number of lamps                                | 1 piece/unit  |
| Suitable for outdoor use                       | Yes           |
| Number of products on MCB (16 A type B) (nom.) | 5             |
| Default lamp selected                          | CPO45         |
| Automatic restart                              | Yes           |
| Operating and Electrical                       |               |
| Input Voltage                                  | 208-240-277 V |
| Input frequency                                | 50 to 60 Hz   |
| Minimum mains voltage operation (min.)         | 172 V         |
| Operating frequency (nom.)                     | 0.40 kHz      |
| Power factor 100% load (nom.)                  | 0.96          |
| Ignition voltage (max.)                        | 5 kV          |
| Ignition switch-off time (nom.)                | 20 min        |
| Mains voltage performance (AC)                 | 188-305V      |
| Mains voltage safety (AC)                      | 160-305V      |
| Earth leakage current (max.)                   | 0.7 mA        |
| Output peak voltage (max.)                     | 250 V         |

|                             |         |
|-----------------------------|---------|
| Inrush current width        | 0.24 ms |
| Lamp power tolerance        | -3%/+3% |
| Input current (nom.)        | 0.26 A  |
| Inrush current peak (max.)  | 28 A    |
| Efficiency at full load [%] | 89.23 % |

### Wiring

|   |                           |
|---|---------------------------|
| Cable capacity output wires mutual (nom.) | 1000 pF                   |
| Cable length from device to lamp          | 10 m                      |
| Wire strip length                         | 10.0-11.0 mm              |
| Ballast contact wire cross section        | 0.50-2.50 mm <sup>2</sup> |
| Connector type                            | WAGO series 804           |

### System characteristics

|                                 |       |
|---------------------------------|-------|
| Rated ballast-lamp power        | 45 W  |
| Rated lamp power on CPO         | 45 W  |
| System power on CPO             | 51 W  |
| Lamp power on CPO               | 45 W  |
| Power loss on CPO               | 6 W   |
| Power loss on CPO while dimming | 4.5 W |

# PrimaVision Xtreme for CPO

| Temperature              |        |
|--------------------------|--------|
| T-ambient (max.)         | 55 °C  |
| T-ambient (min.)         | -30 °C |
| T storage (max.)         | 55 °C  |
| T storage (min.)         | -30 °C |
| T-case lifetime (nom.)   | 80 °C  |
| T-case switch off (min.) | 92 °C  |

| Controls and Dimming         |                        |
|------------------------------|------------------------|
| Programmable lamp settings   | None                   |
| Pre-set integrated controls  | None                   |
| Programmable dimming options | None                   |
| Control input protection     | Yes (Basic insulation) |
| Regulating level             | -                      |

| Mechanical and Housing |   |
|------------------------|---|
| Housing                | Q |

| Approval and Application               |   |
|--|---|
| Surge protection (common/differential) | EN61547 (L-L 2kV, L-G 4kV), 10kV TIL kV   |
| IP luminaire classification            | 34  |
| Active temperature protection          | Yes   |
| EMI 9 kHz ... 300 MHz                  | CISPR 15 ed 7.2   |
| EMI 30 MHz ... 1,000 MHz               | CISPR15 Edition 7.2   |
| Safety standard                        | IEC 607, 609, 926, 928 [ No Standard for HID Lamp drivers exists. Requirements in |

|                                    |   |
|------------------------------------|---|
|                                    | these standards to be used if considered relevant for the product.] |
| Quality standard                   | ISO 9000:2000   |
| Environmental standard             | ISO 14001   |
| Harmonic current emission standard | IEC 61000-3-2   |
| Vibration standard                 | IEC 68-2-6 Fc (10-150Hz, 2G)  |
| Bumps standard                     | IEC 68-2-29 Eb (10G/16ms)   |
| Humidity standard                  | EN 61347-2-12 clause 11   |
| Approval marks                     | F-Marking CE marking ENEC certificate<br>VDE-EMV certificate        |
| Humming and noise level            | < 30 dB(A)  |

| Product Data                      |                             |
|-----------------------------------|-----------------------------|
| Full product code                 | 871829166896100             |
| Order product name                | HID-PV Xt 45 CPO Q 208-277V |
| EAN/UPC – product                 | 8718291668961               |
| Order code                        | 913700690366                |
| Local order code                  | HIDPVXT45/SCPO              |
| SAP numerator – quantity per pack | 1                           |
| Numerator – packs per outer box   | 12                          |
| SAP material                      | 913700690366                |
| SAP net weight (piece)            | 0.820 kg                    |

## Dimensional drawing

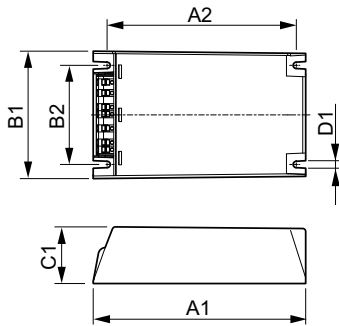

HID-PV Xt 45 CPO Q 208-277V

| Product                     | D1     | C1      | A1       | A2       | B1      | B2      |
|-----------------------------|--------|---------|----------|----------|---------|---------|
| HID-PV Xt 45 CPO Q 208-277V | 4.5 mm | 40.0 mm | 150.0 mm | 133.6 mm | 90.0 mm | 70.0 mm |

## PrimaVision Xtreme for CPO

