

GreenPerform Troffer RC100B

Mounting instruction

444100007261

ASNZS
60598



$t_a 25^{\circ}\text{C}$

IP 20



CE



Type	Voltage	Power	Flux (lm)	Dimension LxWxH (cm)	kg
RC100B LED27S W60L60 PSU OC CAU	220-240V~	23W	2700	59.7x59.7x4.6	2.8
RC100B LED37S W60L60 PSU OC CAU	220-240V~	32W	3700	59.7x59.7x4.6	2.8
RC100B LED37S W60L120 PSU OC CAU	220-240V~	32W	3700	119.7x59.7x4.6	5
RC100B LED37S W60L60 PSD OC CAU	220-240V~	32W	3700	59.7x59.7x4.6	2.8
RC100B LED37S W60L120 PSD OC CAU	220-240V~	32W	3700	119.7x59.7x4.6	5

RC600B W60L60

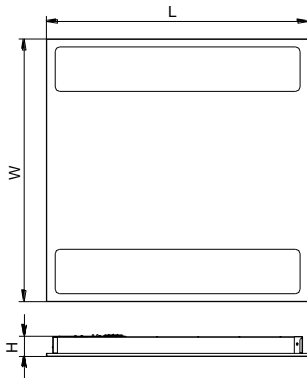

RC600B W60L120

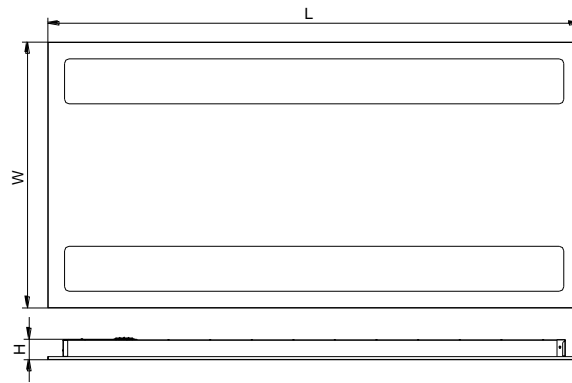

OC with UGR ≤ 19 version

Recessed Mounting

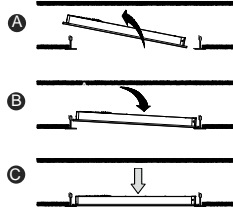
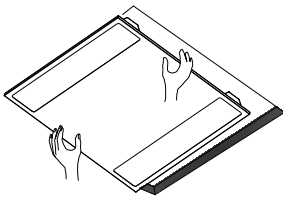

Safety Chain Via Hook

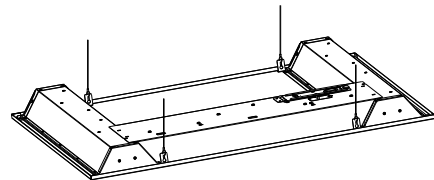

Safety chain is not included.
Customers need to buy separately.

Supply Connection

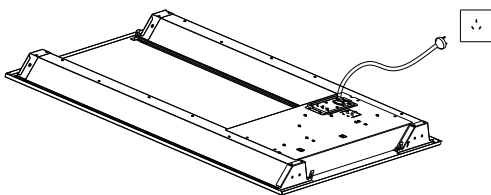

Connect DALI cable

For PSD/Coded light series only

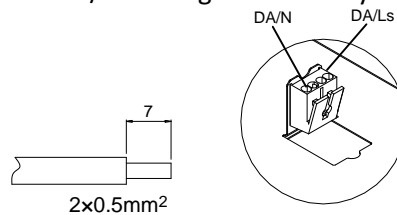

2x0.5mm²

For PSD Series only

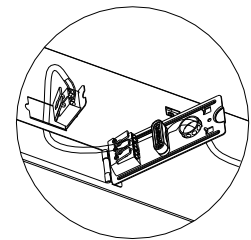

WARNING — RISK OF OVERHEATING OR FIRE IF THE CLEARANCE DISTANCES ARE COMPROMISED.

RISK OF FIRE — REQUIRED CLEARANCE FROM STRUCTURAL MEMBERS AND BUILDING ELEMENTS

HCB = 180 mm MIC = 0 mm SCB = 75 mm SCI = 0 mm

- (i) HCB (Height clearance to building element)
- (ii) MIC (Minimum insulation clearance)
- (iii) SCB (Side clearance to building element)
- (iv) SCI (Side clearance to insulation)

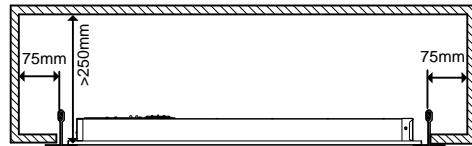

Building insulation abutting the luminaire must meet the following requirements:

- a) Be of a type that can maintain its dimensions and structural integrity when exposed to the maximum surface temperatures of the class of luminaire, being 90°C.
 - b) Be of a type able to withstand a 30 second needle flame test carried out in accordance with AS/NZS 60695.11.5 with the flame applied to all surfaces of the test sample.
- Loose fill insulation as defined in NZS 4246 is not permitted to abut or cover this luminaire or be used anywhere near this downlight.

Inrush current

Product Type	Run Current (A)(@220V)	Start (Inrush) Current(A) / Ipeak (A)	Start Current Duration (µs) / T(@50% of Ipeak) (µs)	Touch current or protective conductor current (mA)	MCB Type B 16A (or Type C 16A) Max no. fitting (pcs)
RCI00B LED27S W60L60 PSU OC CAU	0.19	2.97	302	0.50	≤24
RCI00B LED37S W60L60 PSU OC CAU	0.26	2.97	302	0.50	≤24
RCI00B LED37S W60L120 PSU OC CAU	0.13	17.8	282	0.5	≤24
RCI00B LED37S W60L60 PSD OC CAU	0.26	21	280	1	≤24
RCI00B LED37S W60L120 PSD OC CAU	0.13	21	280	1	≤24



1. Indoor use only.
2. Do not switch on before complete installation.
3. The luminaire shall be installed by a qualified electrician and wired in accordance with the latest IEE electrical regulations or the national requirements.
4. The luminaire shall ,under no circumstance,be covered with insulation matting or similar material.
5. The light source contained in this luminaire shall only be replaced by the manufacturer or his service agent or a similar qualified person.
6. Luminaire must not be used or stored in corrosive environment where hazardous materials such as Sulphur, Chlorine, phthalates, etc, are present.
- 7.For controllable luminaires, basic insulation has been maintained between LV supply and control conductors.