



# SmartBright LED Floodlight

## BVP172 LED43/NW 50W WB GREY SAA KC

LED module 4300 lm

The SmartBright LED Floodlight is a versatile floodlight engineered to deliver significant energy savings, an ideal solution for diverse floodlighting applications. The product is also designed to meet relevant performance and safety standards, offering you reliable and long-lasting performance.

### Product data

General Information	
Lamp family code	LED43 [ LED module 4300 lm]
Lamp colour code	740 neutral white
Light source replaceable	No
Driver included	Yes
Optical cover/lens type	PC-UV [ Polycarbonate bowl/cover UV-resistant]
Luminaire light beam spread	30° x 80°
Control interface	-
Connection	Flying leads/wires
Cable	Cord 0.6 m without plug
Protection class IEC	Safety class I (I)
Flammability mark	F [ For mounting on normally flammable surfaces]
CE mark	CE mark
Constant light output	No
Number of products on MCB (16 A type B)	40

LED engine type	LED
Operating and Electrical	
Input Voltage	220 to 240 V
Input frequency	50 or 60 Hz
Inrush current	2.9 A
Inrush time	0.000225 ms
Power factor (min.)	0.9

Controls and Dimming	
Dimmable	No

Mechanical and Housing	
Housing material	Aluminum die-cast
Optical cover/lens material	Polycarbonate
Mounting device	MBA [ Mounting bracket adjustable]
Optical cover/lens shape	Flat
Optical cover/lens finish	Frosted

# SmartBright LED Floodlight

Overall length	270 mm
Overall width	202 mm
Overall height	38 mm
Effective projected area	0.054 m <sup>2</sup>
Colour	Grey

## Approval and Application

Ingress protection code	IP65 [ Dust penetration-protected, jet-proof]
Mech. impact protection code	IK07 [ 2 J reinforced]
Surge protection (common/differential)	4/2 kV

## Initial Performance (IEC Compliant)

Initial luminous flux (system flux)	4300 lm
Luminous flux tolerance	+/-10%
Initial LED luminaire efficacy	86 lm/W
Lamp colour temperature	4000 K
Colour Rendering Index	>70
Initial chromaticity	SDCM<7
Initial input power	50 W

Power consumption tolerance	+/-10%
-----------------------------	--------

## Application Conditions

Ambient temperature range	-40 to +45 °C
Maximum dimming level	Not applicable

## Product Data

Full product code	871016332085499
Order product name	BVP172 LED43/NW 50W WB GREY SAA KC
EAN/UPC – product	8710163320854
Order code	911401674604
Local code	SBFLED43NW50W
SAP numerator – quantity per pack	1
SAP numerator – packs per outer box	8
SAP material	911401674604
Net Weight (Piece)	1.200 kg



## Dimensional drawing

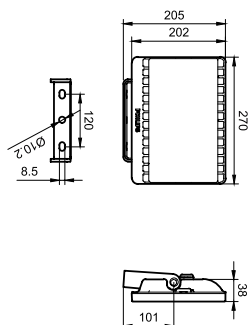

BVP171/172

